

TECHNICAL  
BULLETIN

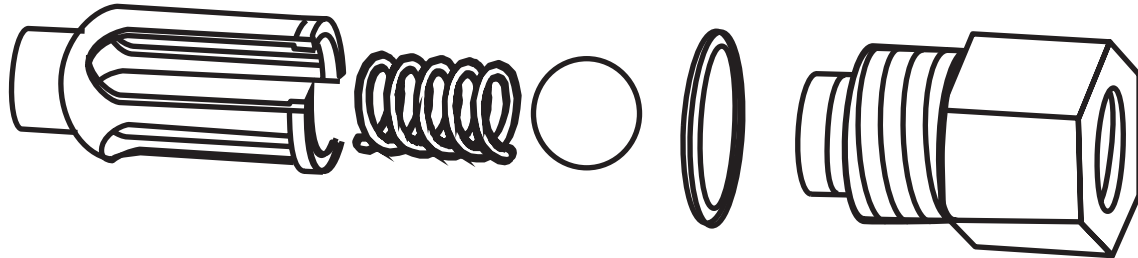

BALL CHECK-VALVE ASSEMBLY

**Ball Check-Valve Repair Procedure:**

Step 1: Use a back-up wrench to hold the check-valve body and remove the fuel hose from the inlet of the Davco Fuel Pro® or Diesel Pro® at the check valve body (Shown Above).

Step 2: Remove the check-valve assembly from the Fuel Pro.

Step 3: Remove Ball, Spring, And Spring Retainer.

Step 4: Clean and inspect the check-valve body. Replace if damaged or if the ball seat is not smooth.

Step 5: Install the new Ball, Spring, and Spring Retainer. Note: The spring retainer snaps into a groove in the check-valve body.

Step 6: Replace the check-valve assembly into the Fuel Pro or Diesel Pro and connect the fuel inlet hose. Use liquid or paste type thread sealant at both thread connections.

Step 7: Prime the fuel system, start the engine and check for any fuel leaks.

**Check Valve Service Parts:**

**Fuel Pro 382** and **Fuel Pro 380 without electric heat** use Body part number 090037 and Service kit part number 101132.

For **Fuel Pro 380 with electric heat** use Body part number 100147 and Service kit part number 101132.

For **Diesel Pro 232** and **Diesel Pro 233** use Body part number 101935 and Service kit part number 101824.